



# Submersible Sewage Pump

**MODEL**

# 3886

Prosurance available for residential applications.

## APPLICATIONS

Specifically designed for the following uses:

- Homes
- Sewage systems
- Dewatering/Effluent
- Water transfer

## SPECIFICATIONS

### Pump:

- Solids handling capabilities: 2" maximum.
- Discharge size: 2" NPT.
- Capacities: up to 185 GPM.
- Total heads: up to 38 feet TDH.
- Temperature: 104°F (40°C) continuous 140°F (60°C) intermittent.
- See order numbers on reverse side for specific HP, voltage, phase and RPM's available.

## FEATURES

- **Impeller:** Cast iron, semi-open, dynamically balanced, non-clog with pump out vanes for mechanical seal protection. Optional Silicon bronze impeller available.
- **Casing:** Cast iron volute type for maximum efficiency. Designed for easy installation on A10-20 slide rail.
- **Mechanical Seal: SILICON CARBIDE VS. SILICON CARBIDE** sealing faces for superior abrasive resistance, stainless steel metal parts, BUNA-N elastomers.
- **Shaft:** Corrosion-resistant stainless steel. Threaded design. Locknut on three phase models to guard

against component damage on accidental reverse rotation.

- **Fasteners:** 300 series stainless steel.
- Capable of running dry without damage to components.
- Designed for continuous operation, when fully submerged.

## MOTORS

- Fully submerged in high grade turbine oil for lubrication and efficient heat transfer. All ratings are within the working limits of the motor.
- **Class B insulation. Single phase (60 Hz):**
  - All single phase models feature capacitor start motors for maximum

- starting torque.
- Built-in overload with automatic reset.
- 1/3 and 1/2 HP – 16/3 SJTOW with 115V or 230V three prong plug.
- 3/4 and 1 HP – 14/3 STOW with bare leads.

### Three phase (60 Hz):

- Overload protection must be provided in starter unit.
- 1/2-1 HP – 14/4 STOW with bare leads.

- **Bearings:** Upper and lower heavy duty ball bearing construction.

- **Designed for Continuous Operation:** Pump ratings are within the motor manufacturer's recommended working limits, can be operated continuously without damage when fully submerged.

- **Power Cable:** Severe duty rated, oil and water resistant. Epoxy seal on motor end provides secondary moisture barrier in case of outer jacket damage and to prevent oil wicking. 20 foot standard with optional lengths available.

- **Motor Cover O-ring:** Assures positive sealing against contaminants and oil leakage.

- Consult factory for information on 575 V models.

## AGENCY LISTINGS



Tested to UL 778 and CSA 22.2 108 Standards By Canadian Standards Association File #LR38549

Goulds Pumps is ISO 9001 Registered.

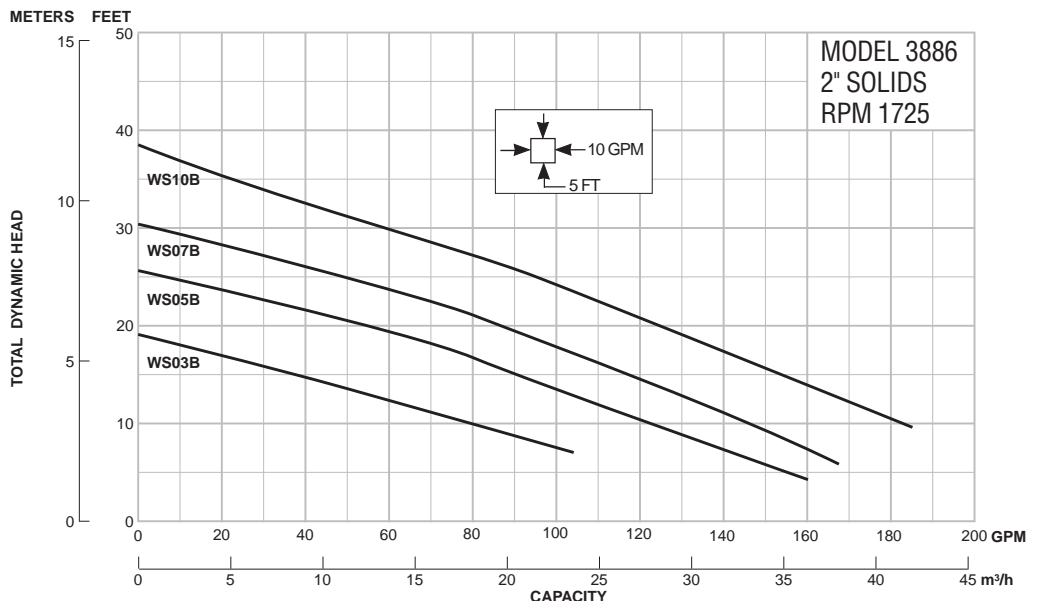

Goulds Pumps



# Submersible Sewage Pump

**MODEL**

# 3886

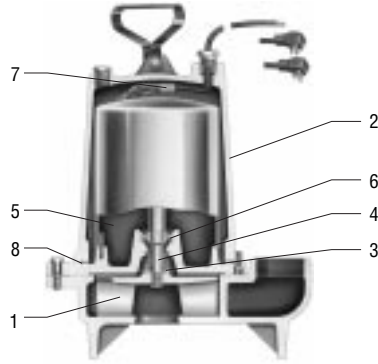

## COMPONENTS

Item No.	Description
1	Multi-vane non-clog cast iron impeller
2	Electrocoat paint outside and inside
3	Silicon carbide vs. silicon carbide mechanical seal
4	Stainless steel shaft
5	High grade turbine oil
6	All ball bearing heavy duty design
7	Epoxy sealed cable
8	O-ring seal

## DIMENSIONS

(All dimensions are in inches. Do not use for construction purposes.)

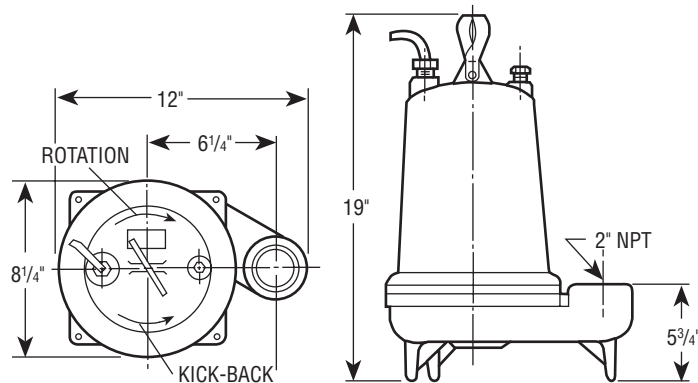

## MODELS

Order No.	HP	Phase	Volts	Max Amps.	RPM	Wt. (lbs.)	Heaters
WS0311B	1/3	1	115	9.8	1750	63	N/A
WS0318B			208	5.5			
WS0312B			230	4.9			
WS0511B	1/2	1	115	14.5		65	N/A
WS0518B			208	8.0			
WS0512B			230	7.3			
WS0538B			200	3.8			
WS0532B	3	3	230	3.3		85	K34
WS0534B			460	1.7			K32
WS0718B			208	11.0			K23
WS0712B	3/4	1	230	9.4		85	N/A
WS0738B			200	4.1			K34
WS0732B			230	3.6	K33		
WS0734B	1	3	460	1.8	85	K23	
WS1018B			208	14.0		N/A	
WS1012B			230	12.3		K42	
WS1038B	1	3	200	6.2	85	K41	
WS1032B			230	5.8		K29	
WS1034B			460	2.9			

## PERFORMANCE RATINGS (gallons per minute)

Order No.	WS03B	WS05B	WS07B	WS10B
<b>HP</b>	1/3	1/2	3/4	1
<b>RPM</b>	1750	1750	1750	1750
<b>Total Head Feet of Water</b>	5	150	-	-
	10	82	122	150
	15	33	90	123
	20	-	50	90
	25	-	7	97
	30	-	-	5
	35	-	-	-

## SEWAGE EJECTOR SYSTEM

**Simplex ejector system** offers ease of ordering and installation. A single ordering number specifies a complete system designed for most residential and commercial sump and sewage pump applications.



**Unassembled Package Order No. SWS0511B**

**Includes:**

- Basin and Cover: A7-1830P
- Check Valve: A9-2P
- Pump: 1/2 HP, 115Volt – WS0511B
- Float Switch: A2-5 (115 V), A2-6 (230 V)  
For 230 Volt application Use Order No. SWS0512B.

Goolds Pumps

