

Repair Parts

MODEL

NPE/NPE-F

TABLE OF CONTENTS

NPE END SUCTION

NPE Product Line Numbering System	1
NPE Seal Chart (Part of Numbering System)	1
Parts List	2
Optional Components	2
Pictorial Breakdown of Pump	3
Impeller Chart Standard Impeller by Impeller Code	4
Impeller Chart by Motor Size at 3500 RPM	4
Motor Chart	5

NOTE:

For units built before September, 1997
The following upgrades are interchangeable.

- (1) Item 349 Guidevane O-Ring was upgraded from O-Ring to Square Seal Ring.
- (2) Pump Components have been upgraded from 304 SS to 316L SS
- (3) Mechanical Seal upgrades as noted on page 1
- (4) Pump Mounting location for motor adapter with foot to pump support are interchangeable.

NPE/NPE-F NUMBERING SYSTEM

1 ST 2 C 1 A 4 F

SEAL VENT/FLUSH OPTION MECHANICAL SEAL and O-RING

4 = Pre-Engineered Standard

For Optional Mechanical Seal modify catalog order no. with Seal Code listed below.

21 Mechanical Seal (5/8" seal)						
Seal Code	Rotary	Stationary	Elastomers	Metal Parts	Part No.	Casing O-Ring
2	Carbon	Sil-Carbide	EPR	316 SS	10K18*	EPR
4			Viton		10K55***	Viton
5	Sil-Carbide		EPR		10K81	EPR
6			Viton		10K62**	Viton

Note: *Replaces obsolete 10K56 **Replaces obsolete 10K29 ***Replaces obsolete 10K46 and 10K24

Impeller Option Code . . . No Adder Required

For Optional Impeller Diameters modify catalog order no. with Impeller code listed below.

Select Optional Impeller Diameter from Pump Performance Curve.

Impeller Code	Pump Size		
	1 x 1¼-6 Diameter	1¼ x 1½-6 Diameter	1½ x 2-6 Diameter
K		6⅛	
G		5 ¹⁵ / ₁₆	5 ³ / ₈
H		5½	5
A	6⅛	5¼	4¾
B	5¾	5 ¹ / ₁₆	4 ⁵ / ₈
C	5 ³ / ₁₆	4 ⁷ / ₈	4 ³ / ₈
D	4¾	4 ⁵ / ₈	4 ¹ / ₁₆
E	4 ⁷ / ₁₆	4¼	3 ⁵ / ₈
F	4 ¹ / ₁₆	3 ⁷ / ₈	

Note: Not recommended for operation beyond printed H-Q curve.

For critical application conditions consult factory.

Note: Not all combinations of motor, impeller and seal options are available for every pump model. Please check with G&L on non-cataloged numbers.

DRIVER

1 = 1PH, ODP 4 = 1 PH, TEFC 7 = 3 PH, XP
 2 = 3 PH, ODP 5 = 3 PH, TEFC 8 = 575 V, XP
 3 = 575 V, ODP 6 = 575 V, TEFC 0 = 1 PH, XP

HP RATING

C = ½ HP F = 1½ HP J = 5 HP
 D = ¾ HP G = 2 HP
 E = 1 HP H = 3 HP

DRIVER: HERTZ/POLE/RPM

1 = 60 HZ, 2 pole, 3500 RPM
 2 = 60 HZ, 4 pole, 1750 RPM
 3 = 60 HZ, 6 pole, 1150 RPM
 4 = 50 HZ, 2 pole, 2900 RPM
 5 = 50 HZ, 4 pole, 1450 RPM

MATERIAL

ST = Stainless Steel

PUMP SIZE

1 = 1 x 1¼ - 6 2 = 1¼ x 1½ - 6 3 = 1½ x 2 - 6

For Frame Mounted version, substitute the letters "FRM" in these positions.

NPE STANDARD REPAIR PARTS LIST

Item No.	Description	Materials of Construction	1ST 1 x 1¼	2ST 1¼ x 1½	3ST 1½ x 2	QTY.
100	Casing	AISI 316L SS	1L81	1L82	1L83	1
101	Impeller		See Impeller chart on page 4			1
108A	Motor adapter with foot		1L80	1		
108B	Motor adapter less foot		1L87			
108C	Motor adapter with foot & flush		1L334			
108D	Motor adapter less foot with flush		1L335			
123	Deflector	BUNA-N	5K7		1	
184A	Seal housing standard	AISI 316L SS	1L79		1	
184B	Seal housing with seal flush		1L333			
240	Motor support	300 SS	4L320		1	
	Rubber channel	Rubber	9K188		1	
304	Impeller locknut	AISI 316 SS	13K286		1	
347	Guidevane	AISI 316L SS	3L23	3L24	3L25	1
		Viton standard	5K269	5K270		
		EPR	5K273	5K274		
349	Seal ring, guidevane	BUNA	5K271	5K272		1
		AISI 410 SS	13L65			
		Steel/plated	13K252			
383	Mechanical seal	See Mechanical Seal Chart on Page 1				1
408	Drain and vent plug, casing	AISI 316 SS	6L3		2	
412B	O-ring, drain plugs	Viton, standard	5L99		2	
		EPR	5L80			
		BUNA	5L62			
513	O-ring, casing	Viton standard	5K206		1	
		EPR	5K193			
		BUNA	5K4			
575	Pipe Cap	304 SS	6K150		1	

NOTE:
OPTIONAL SEAL FLUSH COMPONENTS

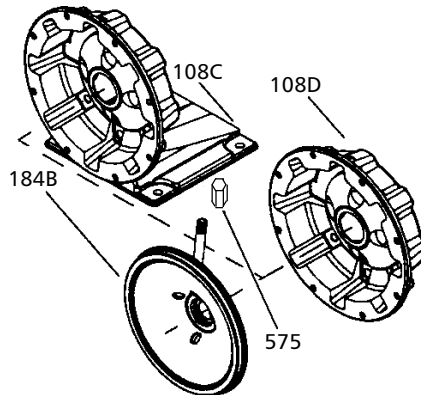

NOTE:

Close coupled units supplied with ½ HP 1750 RPM, ½ - 3 HP Explosion Proof or 5 HP motors, utilize motor adapter less foot and a footed motor.

NOTE:

Frame mounted units (NPE-F) utilize the XS Power Frame and motor adapter less foot. For repair parts for the power frame refer to the XS-Power frame repair parts page in the parts section of your catalog. To order the power frame complete order item 14L61.

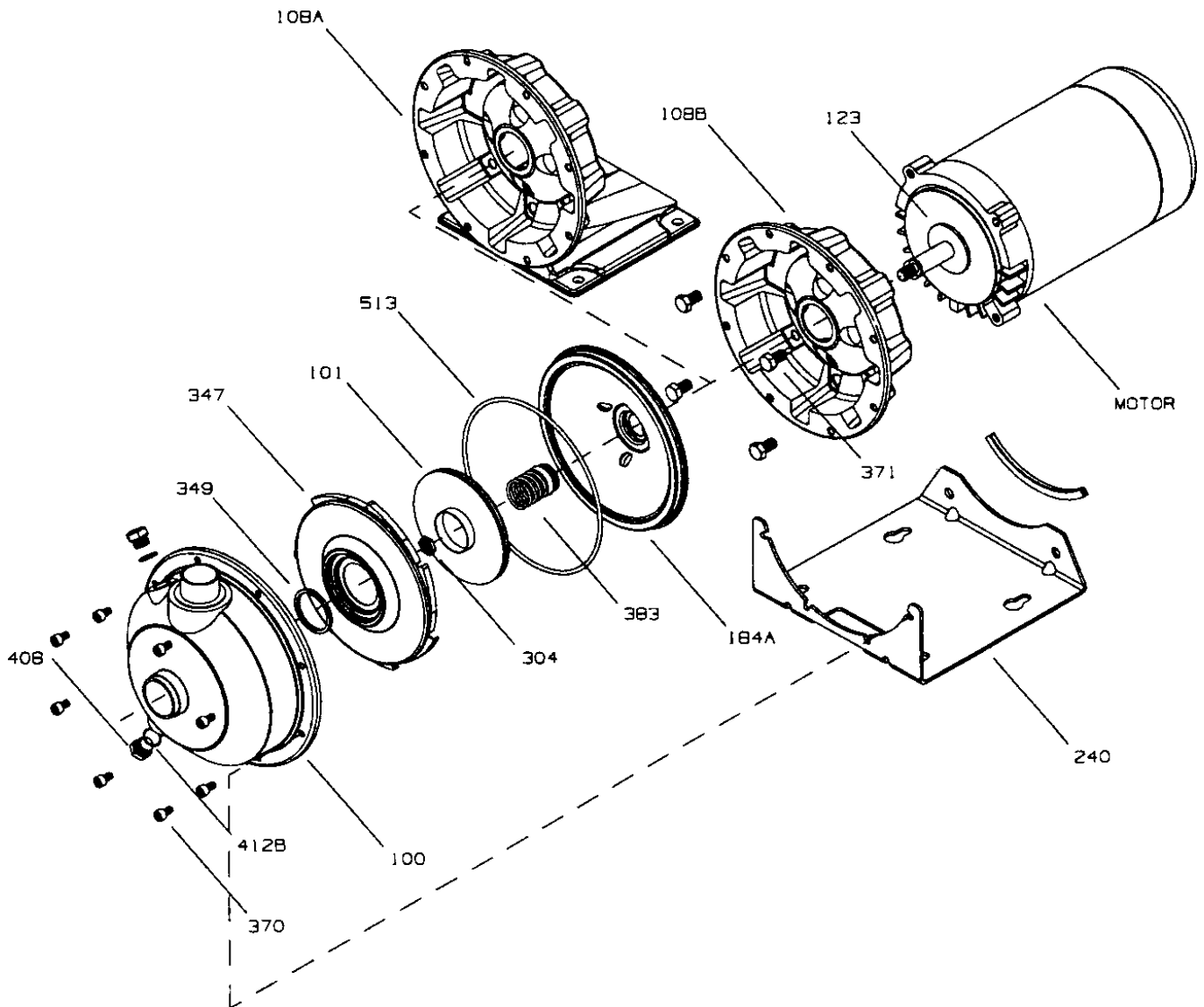

NPE STANDARD IMPELLERS

Impeller Code	Pump Size					
	1 x 1¼-6		1¼ x 1½-6		1½ x 2-6	
	Diameter	Part No.	Diameter	Part No.	Diameter	Part No.
K			6⅞	2L885		
G			5 ¹⁵ / ₁₆	2L700	5 ³ / ₈	2L702
H			5½	2L699	5	2L701
A	6⅞	2L47	5¼	2L48	4¾	2L49
B	5¾	2L44	5 ¹ / ₁₆	2L54	4 ⁵ / ₈	2L58
C	5 ³ / ₁₆	2L46	4 ⁷ / ₈	2L53	4 ³ / ₈	2L57
D	4¾	2L42	4 ⁵ / ₈	2L52	4 ¹ / ₁₆	2L56
E	4 ⁷ / ₁₆	2L45	4¼	2L51	3 ³ / ₈	2L55
F	4 ¹ / ₁₆	2L59	3 ⁷ / ₈	2L50		

NPE STANDARD IMPELLERS BY MOTOR SIZE AT 3500 RPM

For ODP/TEFC Units Built After September 1, 1997

HP	HP Code		1ST		2ST		3ST	
			ODP/TEFC		ODP/TEFC		ODP/TEFC	
½	C	Repair #	2L45					
		Dia.	4 ⁷ / ₁₆					
		Imp. Code	E					
¾	D	Repair #	2L42	2L50				
		Dia.	4¾	3 ⁷ / ₈				
		Imp. Code	D	F				
1	E	Repair #	2L46	2L51	2L55			
		Dia.	5 ³ / ₁₆	4¼	3 ⁵ / ₈			
		Imp. Code	C	E	E			
1½	F	Repair #	2L44	2L52	2L56			
		Dia.	5¾	4 ⁵ / ₈	4 ¹ / ₁₆			
		Imp. Code	B	D	D			
2	G	Repair #	2L47	2L53	2L57			
		Dia.	6⅞	4 ⁷ / ₈	4 ³ / ₈			
		Imp. Code	A	C	C			
3	H	Repair #	2L47	2L48	2L49			
		Dia.	6⅞	5¼	4¾			
		Imp. Code	A	A	A			
5	J	Repair #		2L700	2L885	2L702		
		Dia.		5 ¹⁵ / ₁₆	6⅞	5 ³ / ₈		
		Imp. Code		G	K	G		

For Current Explosion Proof and All Units Built Before September 1, 1997

HP	HP Code		1ST		2ST		3ST	
			ODP	TEFC/EXP	ODP	TEFC/EXP	ODP	TEFC/EXP
½	C	Repair #	2L45	2L59				
		Dia.	4 ⁷ / ₁₆	4 ¹ / ₁₆				
		Imp. Code	E	F				
¾	D	Repair #	2L42	2L45	2L50			
		Dia.	4¾	4 ⁷ / ₁₆	3 ⁷ / ₈			
		Imp. Code	D	E	F			
1	E	Repair #	2L46	2L42	2L51	2L50	2L55	
		Dia.	5 ³ / ₁₆	4¾	4¼	3 ⁷ / ₈	3 ⁵ / ₈	
		Imp. Code	C	D	E	F	E	
1½	F	Repair #	2L44	2L46	2L52	2L51	2L56	2L55
		Dia.	5¾	5 ³ / ₁₆	4 ⁵ / ₈	4¼	4 ¹ / ₁₆	3 ⁵ / ₈
		Imp. Code	B	C	D	E	D	E
2	G	Repair #	2L47	2L44	2L53	2L52	2L57	2L56
		Dia.	6⅞	5¾	4 ⁷ / ₈	4 ⁵ / ₈	4 ³ / ₈	4 ¹ / ₁₆
		Imp. Code	A	B	C	D	C	D
3	H	Repair #	2L47	2L47	2L48	2L54	2L49	2L58
		Dia.	6⅞	6⅞	5¼	5 ¹ / ₁₆	4¾	4 ⁵ / ₈
		Imp. Code	A	A	A	B	A	B
5	J	Repair #			2L700	2L885	2L702	
		Dia.			5 ¹⁵ / ₁₆	6⅞	5 ³ / ₈	
		Imp. Code			G	K	G	

Note:** Max. Explosion Proof rating is 2 HP.

NPE CLOSE-COUPLED MOTORS

MODEL NPE 3500 RPM

HP	Single-Phase, 60 Hz, 115/230 V**, 56J Frame								
	Open, Drip-Proof ^①			Totally Enclosed, Fan Cooled			Explosion Proof		
	Order No.	Max. Amps	Wt. (lbs.)	Order No.	Max. Amps	Wt. (lbs.)	Order No.	Max. Amps	Wt. (lbs.)
½	C04853	10.0/5.0	16	C04821	6.2/3.1	21	BBC04825	6.2/3.1	47
¾	C05853	14.0/7.0	19	C05821	8.8/4.4	24	BBC05825	8.8/4.4	41
1	C06853	16.0/8.0	22	C06821	11.6/5.8	26	BBC06825	11.6/5.8	49
1½	C07858	21.4/10.7	31	C07821	16.2/8.1	35	BBC07825	16.2/8.1	56
2	C08854	26.8/13.4	36	C08821	20.8/10.4	39	BBC08825	20.8/10.4	60
3	C09854	14.0	40	C09821	11.89	44			
5	M10754	14.4	55						

Note:** 3 and 5 HP Single-Phase motors are 230 V only.

HP	Three-Phase, 60 Hz, 208-230/460 V, 56J Frame								
	Open, Drip-Proof ^①			Totally Enclosed, Fan Cooled			Explosion Proof		
	Order No.	Max. Amps	Wt. (lbs.)	Order No.	Max. Amps	Wt. (lbs.)	Order No.	Max. Amps	Wt. (lbs.)
½	C04873	2.6/1.3	19	C04876	1.9/.95	18	BBC04875	1.9/.95	27
¾	C05873	3.4/1.7	19	C05876	2.3/1.15	21	BBC05875	2.3/1.15	30
1	C06873	4.2/2.1	22	C06876	3.2/1.6	21	BBC06875	3.2/1.6	30
1½	C07878	5.8/2.9	25	C07876	4.8/2.4	27	BBC07875	4.8/2.4	37
2	C08874	6.9/3.3	39	C08876	5.4/2.7	33	BBC08875	5.4/2.7	44
3	C09874	7.2/3.6	31	C09876	7.6/3.8	37			
5	M10774	7.2/14.4	50	C10876	6.2/12.4	48			

① For vertical mounting order motor canopy separately - 9K272 for ½, ¾ and 1 HP single phase or 9K273 for all other ODP motors.

MODEL NPE 1750 RPM

HP	Single-Phase, 60 HZ, 115/230 V, 56J Frame								
	Open, Drip-Proof ^①			Totally Enclosed, Fan Cooled			Explosion Proof		
	Order No.	Max. Amps	Wt. (lbs.)	Order No.	Max. Amps	Wt. (lbs.)	Order No.	Max. Amps	Wt. (lbs.)
½	C04811	8.6/4.3	19	C04812	8.0/4.0	20	BBC04815	8.0/4.0	45

HP	Three-Phase, 60 HZ, 208-230/460 V, 56J Frame								
	Open, Drip-Proof ^①			Totally Enclosed, Fan Cooled			Explosion Proof		
	Order No.	Max. Amps	Wt. (lbs.)	Order No.	Max. Amps	Wt. (lbs.)	Order No.	Max. Amps	Wt. (lbs.)
½	C04831	3.76/4.0/2.0	20	C04832	1.77/1.6/.8	20	BBC04835	1.77/1.6/.8	45

Note: Explosion Proof Motors are class 1 and 2, Group D

XS-Group power frame for
models NPE-F, ICS-F, 3742

Repair Parts

MODEL

XS-Group Power Frame

Effective May, 1994

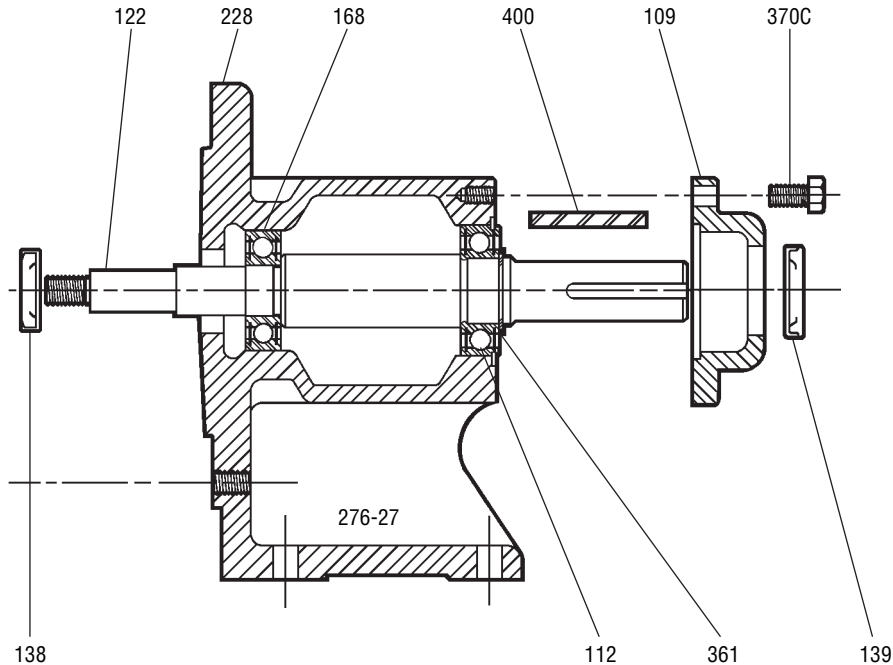

ITEM NO.	PART NO.	DESCRIPTION	MATERIAL	PATTERN NO.
109	1K267	Bearing cover	Cast iron	59142
228	1K268	Bearing frame	Cast iron	59279
122	4K377	Shaft – bearing frame	AISI 303 SS	
400	4K322	Shaft key – motor end		
168	4K384	Ball bearing – inboard bearing	Steel	
112	4K385	Ball bearing – outboard bearing		
138	5K172	Lip seal – inboard	BUNA-N/steel	
139	5K171	Lip seal – outboard		
361	5K211	Retaining ring		
370C	13K179	Hex head cap screw – bearing cover	Steel	

For parts pricing and package stock quantities, refer to published parts price list using “K” part no. listed above.
For complete power frame assembly use part #14L61.

